



# OPTIM-R<sup>®</sup> Roofing System

NEXT GENERATION INSULATION SOLUTION FOR  
FLAT ROOFS



- Optimum performance rigid vacuum insulation panel with a declared thermal conductivity of 0.007 W/m·K
- Insulating performance up to five times better than other commonly available insulation materials
- Over 90% (by weight) recyclable
- Resistant to the passage of water vapour
- Ideal for new build and refurbishment
- Non-deleterious material



*Low Energy –  
Low Carbon Buildings*

# Introduction

## The Problem

When constructing a roof in new-build situations or replacing a roof in existing buildings there may be a requirement for both low U-values and the thinnest possible roof build-up.

For new-build applications, there are increasing regulatory requirements and economic reasons to improve energy efficiency. One of the approaches is to improve the thermal performance of the building fabric, whilst keeping the overall construction as thin as possible. There are already high performance insulation products available that will fulfil the majority of these requirements, however in certain areas, for example where the design demands it, a new, thinner, product is needed.

In refurbishment there is arguably a greater need to keep roof build-ups as thin as possible. In certain applications internal space may be at a premium or there may be little space for installing new roof insulation, for example in buildings with planning height restrictions.

## The Solution

The **Kingspan OPTIM-R® Roofing System** has been developed to help solve these problems. The **Kingspan OPTIM-R® Roofing System** is an optimum performance next generation insulation solution from Kingspan Insulation. It comprises of rigid vacuum insulation panels with a micro-porous core which is evacuated, encased and sealed in a thin, gas-tight envelope, giving outstanding thermal conductivity, with the thinnest possible solution to insulation problems. The vacuum insulation panels are accompanied with rigid thermoset polyisocyanurate (PIR) insulation infill panels which can be cut to fit around problem areas such as roof lights or ventilator kerbs.

In retrofit applications, the **Kingspan OPTIM-R® Roofing System** provides solutions for areas that previously would have remained un-insulated because of insufficient space available.

In new constructions, the **Kingspan OPTIM-R® Roofing System** can significantly enhance U-values in areas that would otherwise be accepted as denigrating the overall thermal performance.

With a declared thermal conductivity ( $\lambda$ ) of 0.007 W/m·K, the **Kingspan OPTIM-R®** element of the **Roofing System** provides an insulating performance that is up to five times better than other commonly available insulation materials.

The high level of thermal efficiency with minimal thickness, achieved by the **Kingspan OPTIM-R® Roofing System** provides solutions for applications where a lack of construction depth or space is an issue.

# Design Considerations

## Design Services

The **Kingspan OPTIM-R® Roofing System** comes with a supporting design service which ensures the ratio of the **Kingspan OPTIM-R®** element of the **Roofing System** to the **Kingspan OPTIM-R® Roofing System** infill panel for each project is maximised. The panel layout will be designed quickly and effectively, ready for client approval. Each layout will illustrate the size, number and location of the **Kingspan OPTIM-R®** panels. It will also illustrate the size, number and location of any **Kingspan OPTIM-R® Roofing System** infill panels required. Examples of a typical design layout can be seen in Figures 1 & 3.

For more details please contact the Kingspan Insulation Technical Service Department (see rear cover).

### Condensation Risk Analysis

Included in the design service is the calculation of condensation risk in accordance with BS 5250: 2002 (Code of practice for control of condensation in buildings). This ensures that any predicted dew point is above the vapour control layer at the point of minimum thickness of the **Kingspan OPTIM-R® Roofing System**, whilst also ensuring any condensation risk is within the limits given in BS 5250: 2002.

### Assumptions

The U-values in the tables that follow have been calculated, under a management system certified to the BBA Scheme for Assessing the Competency of Persons to Undertake U-value and Condensation Risk Calculations, using the method detailed in BS / I.S. EN ISO 6946: 2007 (Building components and building elements. Thermal resistance and thermal transmittance. Calculation method) and using the conventions set out in BR443 (Conventions for U-value calculations). They are valid for the constructions shown in the details adjacent to each table.



*N.B. For the purposes of these calculations the standard of workmanship has been assumed good and therefore the correction factor for air gaps has been ignored.*

*N.B. The figures quoted are for guidance only. A detailed U-value calculation together with condensation risk analysis should be completed for each individual project.*

*N.B. To gain a comprehensive U-value calculation for your project please consult the Kingspan Insulation Technical Service Department for assistance (see rear cover).*

## Typical Roofing Designs for the *Kingspan OPTIM-R*® Roofing System

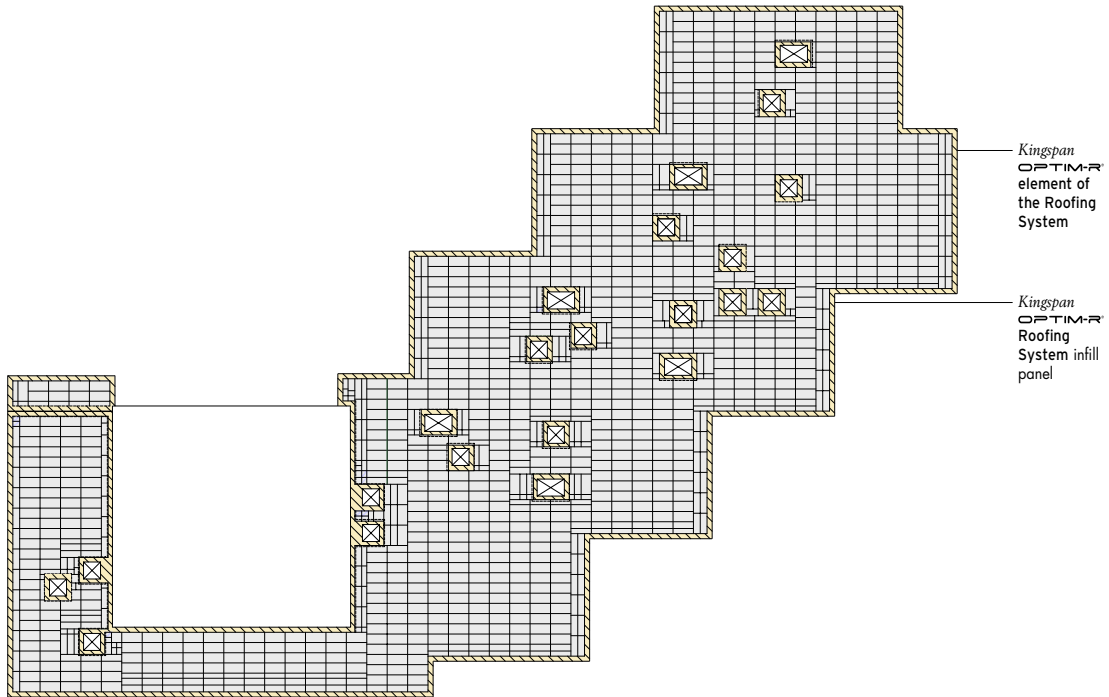

Figure 1

## Concrete Deck

### Dense Concrete Deck with Suspended Ceiling



Figure 2

\* Refer to Sitework.

The *Kingspan OPTIM-R*® Roofing System, when used in the design in Figure 1 and when installed on top of a dense concrete deck with suspended ceiling (Figure 2), can achieve the following U-values using a combined thickness of both the *Kingspan OPTIM-R*® Roofing System and a *Kingspan Thermaroof*® TR27 LPC/FM overlay:

<i>Kingspan OPTIM-R</i> ® Roofing System thickness (mm)	<i>Kingspan Thermaroof</i> ® TR27 LPC/FM overlay thickness (mm)	U-values (W/m <sup>2</sup> ·K)
40	25	0.16
50	25	0.14
50	30	0.13
30 + 30	25	0.12
40 + 30	25	0.11
40 + 30	30	0.10
40 + 40	25	0.09

\* Based on 11% bridging of the *Kingspan OPTIM-R*® Roofing System infill panel.

# Design Considerations

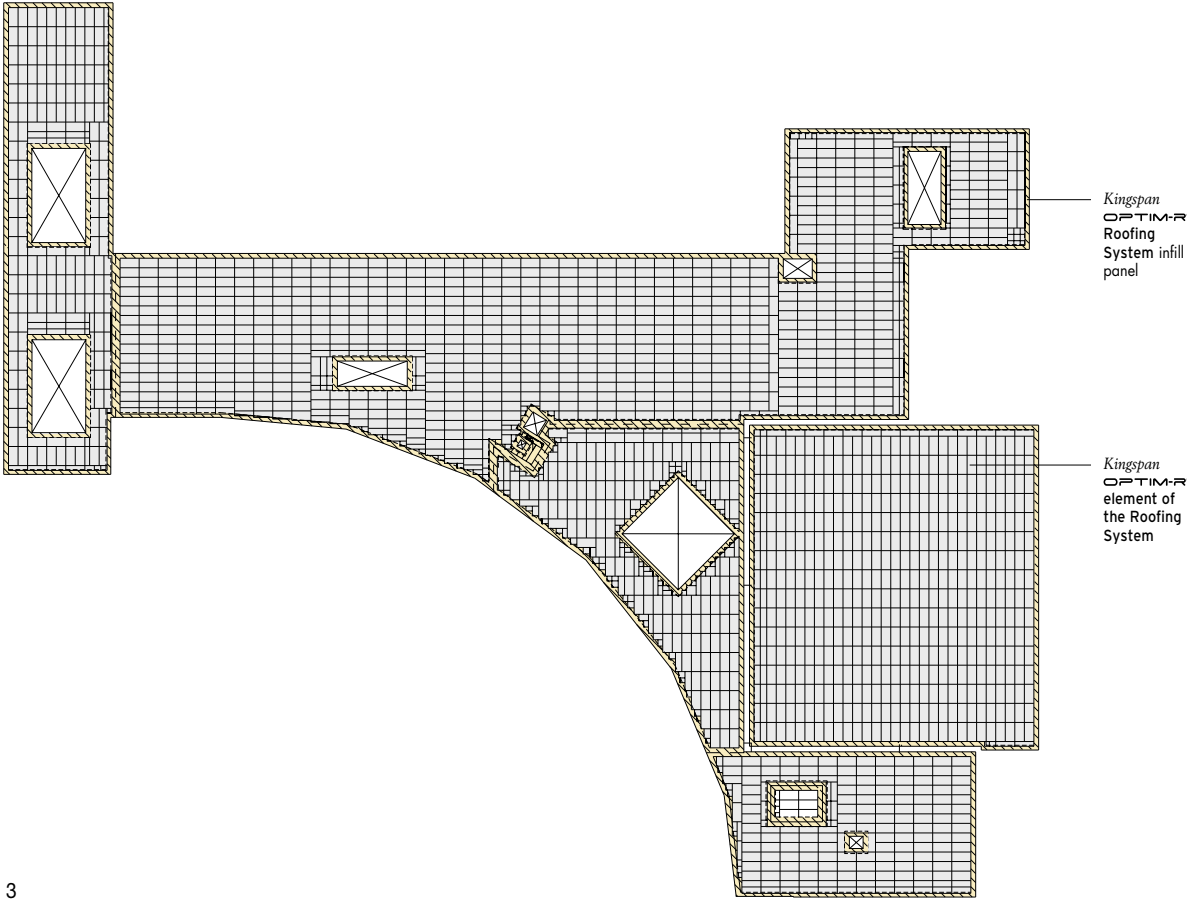

Figure 3

## Timber Deck

### Timber Deck with Plasterboard Ceiling

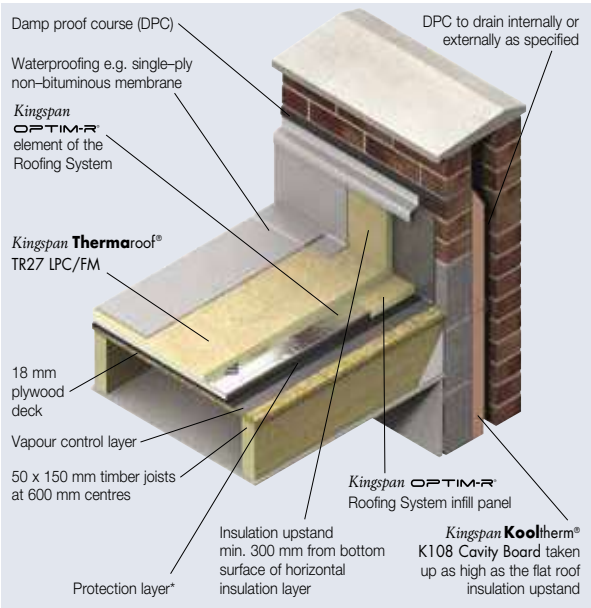

Figure 4

\* Refer to Sitework.

The Kingspan OPTIM-R Roofing System, when used in the design in Figure 3 and when used on top of a timber deck with plasterboard ceiling (Figure 4), can achieve the following U-values using a combined thickness of both the Kingspan OPTIM-R Roofing System and a Kingspan Thermo roof TR27 LPC/FM overlay:

Kingspan OPTIM-R Roofing System thickness (mm)	Kingspan Thermo roof TR27 LPC/FM overlay thickness (mm)	U-values (W/m <sup>2</sup> ·K)
40	25	0.16
50	25	0.14
50	30	0.13
30 + 30*	25	0.12
40 + 30*	25	0.10
40 + 30*	30	0.10
40 + 40*	25	0.09

\* Based on 10.37% bridging of the Kingspan OPTIM-R Roofing System infill panel.

## Linear Thermal Bridging

Reasonable provision must be made to limit the effects of cold bridging. The design should ensure that roof-light or ventilator kerbs etc. are insulated with a 25 mm thick *Kingspan Thermaroof*<sup>®</sup> TR27 LPC/FM board. A 25 mm thick *Kingspan Thermaroof*<sup>®</sup> TR27 LPC/FM upstand should also be used around the perimeter of the roof on the internal façade of parapets. A minimum distance of 300 mm should be maintained between the top of the insulation upstand and the bottom of the horizontal roof insulation. Wall insulation should also be carried up into parapets as high as the flat roof insulation upstand.

Please contact the Kingspan Insulation Technical Service Department (see rear cover) for further advice.

## Responsible Sourcing

*Kingspan OPTIM-R*<sup>®</sup> produced at Kingspan Insulation's Pembridge manufacturing facility is certified to BES 6001 (Framework Standard for the Responsible Sourcing of Construction Products) 'Very Good'.



N.B. The above information is correct at the time of writing. Please confirm at the point of need by contacting Kingspan Insulation's Technical Service Department (see rear cover), from which a copy of Kingspan Insulation's BES 6001 certificate can be obtained.

## Sustainability & Responsibility

Kingspan Insulation has a long-term commitment to sustainability and responsibility: as a manufacturer and supplier of insulation products; as an employer; as a substantial landholder; and as a key member of its neighbouring communities.

A report covering the sustainability and responsibility of Kingspan Insulation Ltd's British operations is available at [www.kingspaninsulation.co.uk/sustainabilityandresponsibility](http://www.kingspaninsulation.co.uk/sustainabilityandresponsibility).

## NBS Specifications

Details also available in NBS Plus. NBS users should refer to clause(s): J42 420, J42 430, J31 335 (Standard and Intermediate) J42 10, J31 10 (Minor Works).



## Wind Loading

Wind loadings should be assessed in accordance with BS 6399-2: 1997 (Loadings for buildings. Code of practice for wind loads) or BS / I.S. EN 1991-1-4: 2005 (National Annex to Eurocode 1 Actions on Structures. General Actions. Wind Actions) taking into account:

- length / width / height of the building;
- orientation of the building;
- wind speed;
- aspect (e.g. on a hill side); and
- topographical value of the surrounding area.

## Falls

The fall on a flat roof, constructed using the *Kingspan OPTIM-R*<sup>®</sup> Roofing System, is normally provided by the supporting structure being directed towards the rainwater outlets. The fall should be smooth and steep enough to prevent the formation of rainwater ponds. In order to ensure adequate drainage, BS 6229: 2003 (Flat roofs with continuously supported coverings. Code of practice) recommends uniform gradients of not less than 1 in 80. However, because of building settlement, it is advisable to design in even greater falls. These can be provided by the *Kingspan OPTIM-R*<sup>®</sup> Roofing System when used with an overlay of *Kingspan ThermoTaper*<sup>®</sup> TT47 LPC/FM (see below).

## Tapered Roofing

The *Kingspan OPTIM-R*<sup>®</sup> Roofing System can also be used in a tapered roofing scheme. The scheme comes with a supporting design service. This ensures that the most cost-effective solution for a roof is identified and that the end result is a tapered system design which meets a roof's rainwater run-off and insulation requirements. For more details please contact the Kingspan Insulation Tapered Roofing Department (see rear cover), which should be consulted as early as possible in the process of designing a roof.

## Green Roofs

The *Kingspan OPTIM-R*<sup>®</sup> Roofing System is suitable for use under most warm green roof systems.

Green roof systems are a specialist design area. When designing a loose-laid insulated green roof assembly consideration needs to be given to the following.

Green roof systems are required to have a minimum dry weight of 80 kg/m<sup>2</sup> to ballast the insulation boards beneath them. However, the total required dry weight will depend upon wind uplift, which in turn will vary with the geographical location of the building, local topography, and the height and the width of the roof concerned. The necessity for any additional dry weight should be assessed in accordance with BS 6399-2: 1997 (Loading for Buildings. Code of practice for wind loads) or BS / I.S. EN 1991-1-4: 2005 (National Annex to Eurocode 1 Actions on structures. General Actions. Wind Actions).

When installing a loose-laid insulated green roof assembly, any insulation must be immediately over-laid with the green roof system, which must meet all of the requirements outlined above.

Where these requirements cannot be ensured, the insulation must be bonded down (see Sitework). For further information please contact the Kingspan Insulation Technical Service Department (see rear cover).

# Typical Constructions

## Metal Deck

### Metal Deck with No Ceiling

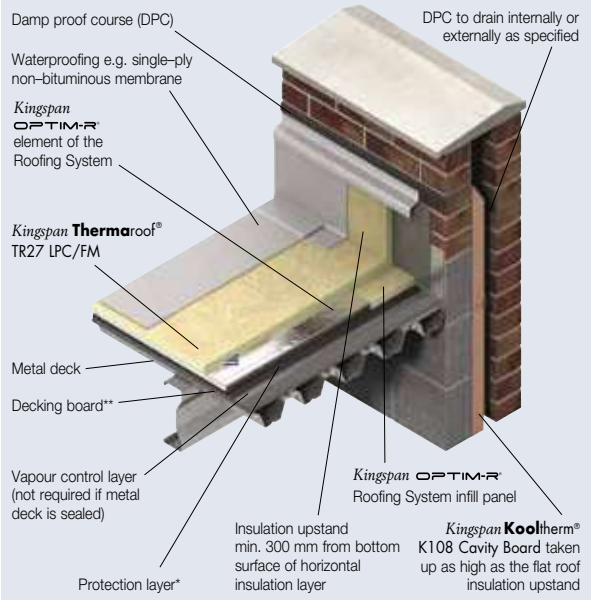

Figure 5

\* Refer to Sitework.  
 \*\* Specification and thickness dependent on metal decking specification.

### Semi-intensive Green Roof Covering – Dense Concrete Deck with Suspended Ceiling

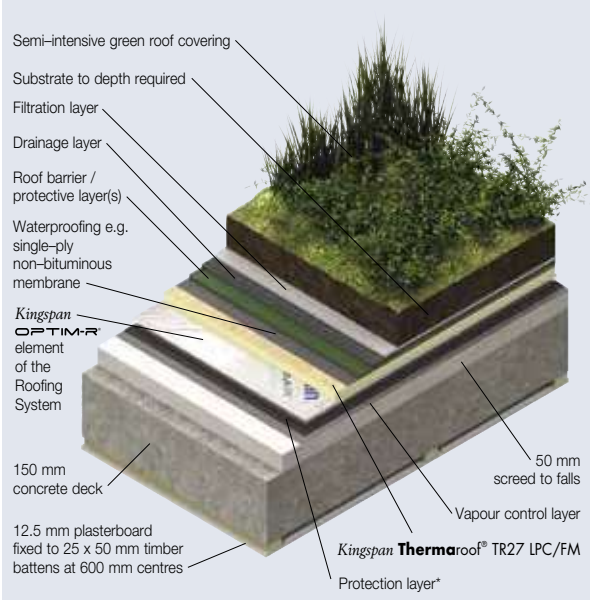

Figure 7

\* Refer to Sitework.

## Green Roof Systems

### Extensive Green Roof Covering – Metal Deck with No Ceiling

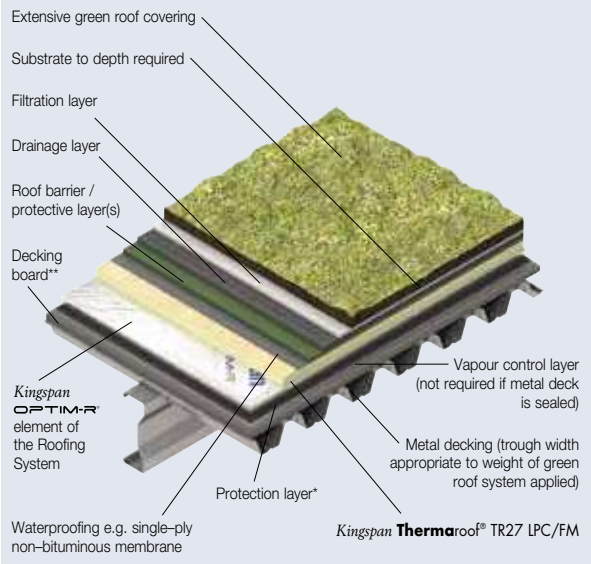

Figure 6

\* Refer to Sitework.  
 \*\* Specification and thickness dependent on metal decking specification.

# Design Considerations

## Roof Waterproofing

The *Kingspan OPTIM-R® Roofing System*, when used in conjunction with an overlay of *Kingspan Thermaroof® TR27 LPC/FM*, is suitable for use with most fully adhered single-ply waterproofing membranes. When using the *Kingspan OPTIM-R® Roofing System* with fully adhered single-ply waterproofing membranes, the joints between the *Kingspan Thermaroof® TR27 LPC/FM*, immediately below the waterproofing membrane, can be taped with a min. 50 mm wide foil tape (refer to the appropriate single-ply membrane manufacturer's instructions). Please contact the Kingspan Insulation Technical Service Department (see rear cover) to check waterproofing membrane and proprietary adhesive system compatibility. Advice should be sought, from the appropriate waterproofing membrane manufacturer, in relation to the requirement for the use of a fleece backed membrane with the waterproofing membrane in question.

The *Kingspan OPTIM-R® Roofing System* is, when used in conjunction with an overlay of *Kingspan Thermaroof® TR27 LPC/FM*, also suitable for use with some cold liquid applied waterproofing systems. When using the *Kingspan OPTIM-R® Roofing System* with cold liquid applied waterproofing systems, a carrier membrane for the waterproofing must be installed over the *Kingspan Thermaroof® TR27 LPC/FM*. Advice should be sought, from the waterproofing system manufacturer, about the specification of the carrier membrane and the compatibility of the waterproofing system with the *Kingspan OPTIM-R® Roofing System*. For further advice please contact the Kingspan Insulation Technical Service Department (see rear cover).

## Water Vapour Control

The *Kingspan OPTIM-R® Roofing System* must be installed over a separate vapour control layer. A minimum vapour control layer should consist of a coated roofing felt complying with Type 3B to BS 747: 2000 (Reinforced bitumen sheets for Roofing. Specification), or S1P1 to BS 8747: 2007 (Reinforced bitumen membranes (RBMs) for roofing. Guide to selection and specification). Alternative vapour control layers should be discussed with the Kingspan Insulation Technical Service Department (see rear cover).

Where the separate vapour control layer is to be bonded, allowance should be made for adequate bonding of the vapour control layer to the substrate, so as to provide a suitable surface upon which to lay the insulation panels and sufficient resistance to wind up-lift (see 'Wind Loading').

# Sitework

## Installing over Concrete Decks

- Concrete decks should be clean, dry, without projections (including fixing heads etc.), steps or gaps, and should be graded to allow correct falls to all rainwater outlets.
- In order to ensure an adequate bond between the concrete deck and the vapour control layer, the concrete deck should be suitably primed, in accordance with the primer manufacturer's instructions, prior to the application of the adhesive system, used to bond the vapour control layer to the deck.
- Where one run of the specified vapour control layer laps another, there should be minimum 150 mm side and end overlaps, which should be adequately sealed.
- Turn up the vapour control layer at the edge of the roof to a height appropriate to the specified waterproofing membrane.
- An optional protection layer may be used under the *Kingspan OPTIM-R® Roofing System*. For further information please contact the Kingspan Insulation Technical Service Department (see rear cover).
- The *Kingspan OPTIM-R®* element of the Roofing System should be laid chessboard pattern where practical, with joints lightly butted. There should be no gaps at abutments.
- Where runs of the *Kingspan OPTIM-R®* element of the Roofing System do not accurately fit the dimension of the roof, the use of *Kingspan OPTIM-R® Roofing System* infill boards is required to make up this difference. Each *Kingspan OPTIM-R® Roofing System* infill panel is to be the same thickness as the *Kingspan OPTIM-R®* element of the Roofing System.
- Both the *Kingspan OPTIM-R®* element of the Roofing System and the *Kingspan OPTIM-R® Roofing System* infill panels should be bonded down using an appropriate proprietary adhesive system.
- At the perimeter of the roof and where upstands or any other penetrations (e.g. roof-lights or ventilator kerbs) are present, *Kingspan OPTIM-R® Roofing System* infill panels should be laid abutting these areas, in strips no less than 200 mm wide, to take account of building tolerances and to provide a zone to allow for peel restraint mechanical fixing of the membrane should it be required. Refer to the waterproofing manufacturer for guidance on appropriate peel restraint detailing.
- The *Kingspan Thermaroof® TR27 LPC/FM* infill panels should be laid as soon as possible to avoid exposure of the *Kingspan OPTIM-R®* element of the Roofing System to direct foot traffic.
- The *Kingspan Thermaroof® TR27 LPC/FM* should be bonded to the upper surface of the *Kingspan OPTIM-R®* element of the Roofing System using an appropriate proprietary adhesive system prior to the application of the waterproof covering.
- Subject to project requirements, a minimum 25mm thick *Kingspan Thermaroof® TR27 LPC/FM* upstand should be used around the perimeter of the roof on the internal façade of parapets.
- A minimum distance of 300 mm should be maintained between the top of the insulation upstand and the bottom of the horizontal roof insulation.
- The waterproofing membrane is installed in accordance with the membrane manufacturer's instructions, over the whole insulated area including any insulation upstands, as soon as possible after laying the insulation boards.



## Installing over Plywood Decks

- Plywood decks should be clean, dry, without projections (including fixing heads etc.), steps or gaps, and should be graded to allow correct falls to all rainwater outlets.
- In order to ensure an adequate bond between the plywood deck and the vapour control layer, the plywood deck should be suitably primed, in accordance with the primer manufacturer's instructions, prior to the application of the adhesive system, used to bond the vapour control layer to the deck.
- Where one run of the specified vapour control layer laps another, there should be minimum 150 mm side and end overlaps, which should be adequately sealed.
- Turn up the vapour control layer at the edge of the roof to a height appropriate to the specified waterproofing membrane.
- An optional protection layer may be used under the *Kingspan OPTIM-R® Roofing System*. For further information please contact the Kingspan Insulation Technical Service Department (see rear cover).
- The *Kingspan OPTIM-R®* element of the Roofing System should be laid chessboard pattern where practical, with joints lightly butted. There should be no gaps at abutments.
- Where runs of the *Kingspan OPTIM-R®* element of the Roofing System do not accurately fit the dimension of the roof, the use of *Kingspan OPTIM-R® Roofing System* infill boards is required to make up this difference. Each *Kingspan OPTIM-R® Roofing System* infill panel is to be the same thickness as the *Kingspan OPTIM-R®* element of the Roofing System.
- Both the *Kingspan OPTIM-R®* element of the Roofing System and the *Kingspan OPTIM-R® Roofing System* infill panels should be bonded down using an appropriate proprietary adhesive system.
- At the perimeter of the roof and where upstands or any other penetrations (e.g. roof-lights or ventilator kerbs) are present, *Kingspan OPTIM-R® Roofing System* infill panels should be laid abutting these areas, in strips no less than 200 mm wide, to take account of building tolerances and to provide a zone to allow for peel restraint mechanical fixing of the membrane should it be required. Refer to the waterproofing manufacturer for guidance on appropriate peel restraint detailing.
- The *Kingspan Thermo roof® TR27 LPC/FM* infill panels should be laid as soon as possible to avoid exposure of the *Kingspan OPTIM-R®* element of the Roofing System to direct foot traffic.
- The *Kingspan Thermo roof® TR27 LPC/FM* should be bonded to the upper surface of the *Kingspan OPTIM-R®* element of the Roofing System using an appropriate proprietary adhesive system prior to the application of the waterproof covering.
- Subject to project requirements, a minimum 25mm thick *Kingspan Thermo roof® TR27 LPC/FM* upstand should be used around the perimeter of the roof on the internal façade of parapets.
- A minimum distance of 300 mm should be maintained between the top of the insulation upstand and the bottom of the horizontal roof insulation.
- The waterproofing membrane is installed in accordance with the membrane manufacturer's instructions, over the whole insulated area including any insulation upstands, as soon as possible after laying the insulation boards.

## Installing over Metal Decks, Existing Flat Roofs and Existing Composite Roof Panels

- The *Kingspan OPTIM-R® Roofing System* is suitable for use over metal decks, existing flat roofs and existing composite roof panels. For further information please contact the Kingspan Insulation Technical Service Department (see rear cover).

# Sitework

## Wheeled / Foot Traffic

- The *Kingspan OPTIM-R*® element of the Roofing System should not be walked on. A protective foot or crawl board should be used during the installation process.
- The *Kingspan OPTIM-R*® Roofing System infill panels and the *Kingspan Thermaroof*® TR27 LPC/FM overlay may be walked on.

## General

- The *Kingspan OPTIM-R*® element of the Roofing System should not be used in association with solvent-based adhesive systems.
- The *Kingspan OPTIM-R*® element of the Roofing System should not be exposed to naked flames or excessive heat.

## Cutting

- The *Kingspan OPTIM-R*® element of the Roofing System should not be cut or penetrated.
- The substrate must be clean, dry and level, and free of sharp objects or edges.
- Cutting of the *Kingspan OPTIM-R*® Roofing System infill panels should be carried out either by using a fine toothed saw, or by scoring with a sharp knife, snapping the board over a straight edge and then cutting the facing on the other side.
- Ensure accurate trimming of the *Kingspan OPTIM-R*® Roofing System infill panels to achieve close-butting joints and continuity of insulation.

## Availability

- Please contact Kingspan Insulation for availability of the *Kingspan OPTIM-R*® Roofing System.

## Packaging and Storage

- The packaging of the *Kingspan OPTIM-R*® Roofing System should not be considered adequate for outdoor protection. The *Kingspan OPTIM-R*® Roofing System should be stored inside a building and raised off the floor.

## Health and Safety

- Kingspan Insulation products are chemically inert and safe to use.
- A Safety Information Data Sheet for this product is available from the Kingspan Insulation website [www.kingspaninsulation.co.uk/safety](http://www.kingspaninsulation.co.uk/safety) or [www.kingspaninsulation.ie/safety](http://www.kingspaninsulation.ie/safety).

*Please note that the reflective surface on this product is designed to enhance its thermal performance. As such, it will reflect light as well as heat, including ultraviolet light. Therefore, if this panel is being installed during very bright or sunny weather, it is advisable to wear UV protective sunglasses or goggles, and if the skin is exposed for a significant period of time, to protect the bare skin with a UV block sun cream.*

*The reflective facing used on this product can be slippery underfoot when wet. Therefore, it is recommended that any excess material should be contained to avoid a slip hazard.*

# Product Details

## Composition

The *Kingspan OPTIM-R* element of the Roofing System comprises a rigid vacuum insulation panel with a microporous core which is evacuated, encased and sealed in a thin, gas-tight envelope.

The *Kingspan OPTIM-R* Roofing System infill panels comprise of a high performance rigid thermoset polyisocyanurate (PIR) insulant, faced on both sides with a coated glass tissue.

## Standards and Approvals

The *Kingspan OPTIM-R* Roofing System is manufactured to the highest standards under a management system certified to ISO 9001: 2008 (Quality Management Systems. Requirements), ISO 14001: 2004 (Environmental Management Systems. Requirements) and OHSAS 18001: 2007 (Health and Safety Management Systems. Requirements).

The use of Kingspan is covered by BDA Agrément Certificate BAE 17-035/02/A (20 – 50 mm) and by LABC Registered Details Certificate No. EWWS488A. For more information please contact the Kingspan Insulation Technical Service Department (see rear cover).



## Standard Dimensions

The *Kingspan OPTIM-R* Roofing System panels are available in the following standard size(s):

Nominal Dimension	Availability
Length (mm)	300 – 1200
Width (mm)	300 – 600
Insulant Thickness (mm)	20 – 60

Other sizes may be available dependent on order quantity. Please contact Kingspan Insulation for more details.

## Compressive Strength

The compressive strength of the *Kingspan OPTIM-R* element of the Roofing System typically exceeds 160 kPa at 10% compression when tested to BS / I.S. EN ISO 826: 1996 (Thermal insulating products for building application. Determination of compression behaviour).

## Durability

If installed correctly and protected from damage and penetration, the *Kingspan OPTIM-R* Roofing System will provide reliable long-term thermal performance over the lifetime of the building.

## Resistance to Solvents, Fungi & Rodents

The *Kingspan OPTIM-R* Roofing System should not be used in association with solvent-based adhesive systems. Damaged boards or boards that have been in contact with solvents or acids should not be used.

The insulation core and facings used in the manufacture of the *Kingspan OPTIM-R* Roofing System resist attack by mould and microbial growth, and do not provide any food value to vermin.

## Fire Performance

The *Kingspan OPTIM-R* Roofing System, when subjected to the British Standard fire test, specified in the table below, will achieve the result shown, when waterproofed with a single-ply waterproofing membrane.

Test	Result
BS 476-3: 2004 or CEN/TS 1187:2012 (External fire exposure roof test)	Dependent on single-ply membrane adopted

Further details on the fire performance of Kingspan Insulation products may be obtained from the Kingspan Insulation Technical Service Department (see rear cover).

## Thermal Properties of the *Kingspan OPTIM-R* element of the Roofing System

The  $\lambda$ -values and R-values detailed below are quoted in accordance with BS / I.S. EN 12667: 2001 (Thermal performance of building materials and products. Determination of thermal resistance by means of guarded hot plate and heat flow meter methods. Products of high and medium thermal resistance), with allowance for ageing and edge effect of the encapsulating film to form the declared value.

### Thermal Conductivity

The *Kingspan OPTIM-R* element of the Roofing System achieves a thermal conductivity ( $\lambda$ -value) of 0.007 W/m·K (declared value allowing for edge effect).

### Thermal Resistance

Thermal resistance (R-value) of the *Kingspan OPTIM-R* element of the Roofing System varies with thickness and is calculated by dividing the thickness of the panel (expressed in metres) by the thermal conductivity.

Insulant Thickness (mm)	Thermal Resistance (m <sup>2</sup> ·K/W)
20	2.857
25	3.571
30	4.285
40	5.714

# Contact Details

## Customer Service

For quotations, order placement and details of despatches please contact the Kingspan Insulation Customer Service Department on the numbers below:

- UK – Tel: +44 (0) 1544 388 601  
– email: [customerservice@kingspaninsulation.co.uk](mailto:customerservice@kingspaninsulation.co.uk)
- Ireland – Tel: +353 (0) 42 979 5000  
– email: [info@kingspaninsulation.ie](mailto:info@kingspaninsulation.ie)

## Literature & Samples

Kingspan Insulation produces a comprehensive range of technical literature for specifiers, contractors, stockists and end users. The literature contains clear 'user friendly' advice on typical design; design considerations; thermal properties; sitework and product data.

Available as a complete Design Manual or as individual product brochures, Kingspan Insulation technical literature is an essential specification tool. For copies please contact the Kingspan Insulation Marketing Department, or visit the Kingspan Insulation website, using the details below:

- UK – Tel: +44 (0) 1544 387 384  
– email: [literature@kingspaninsulation.co.uk](mailto:literature@kingspaninsulation.co.uk)  
– [www.kingspaninsulation.co.uk/literature](http://www.kingspaninsulation.co.uk/literature)
- Ireland – Tel: +353 (0) 42 979 5000  
– email: [info@kingspaninsulation.ie](mailto:info@kingspaninsulation.ie)  
– [www.kingspaninsulation.ie/literature](http://www.kingspaninsulation.ie/literature)

## Tapered Roofing

For technical guidance, quotations, order placement and details of despatches please contact the Kingspan Insulation Tapered Roofing Department on the numbers below:

- UK – Tel: +44 (0) 1544 387 383  
– email: [tapered@kingspaninsulation.co.uk](mailto:tapered@kingspaninsulation.co.uk)
- Ireland – Tel: +353 (0) 42 975 4297  
– email: [tapered@kingspaninsulation.ie](mailto:tapered@kingspaninsulation.ie)

## Technical Advice / Design

Kingspan Insulation supports all of its products with a comprehensive Technical Advisory Service for specifiers, stockists and contractors.

This includes a computer-aided service designed to give fast, accurate technical advice. Simply phone the Kingspan Insulation Technical Service Department with your project specification. Calculations can be carried out to provide U-values, condensation / dew point risk, required insulation thicknesses etc... Thereafter any number of permutations can be provided to help you achieve your desired targets.

The Kingspan Insulation Technical Service Department can also give general application advice and advice on design detailing and fixing etc... Site surveys are also undertaken as appropriate.

The Kingspan Insulation British Technical Service Department operates under a management system certified to the BBA Scheme for Assessing the Competency of Persons to Undertake U-value and Condensation Risk Calculations.



Please contact the Kingspan Insulation Technical Service Department on the numbers below:

- UK – Tel: +44 (0) 1544 387 382  
– email: [technical@kingspaninsulation.co.uk](mailto:technical@kingspaninsulation.co.uk)
- Ireland – Tel: +353 (0) 42 975 4297  
– email: [technical@kingspaninsulation.ie](mailto:technical@kingspaninsulation.ie)

## General Enquiries

For all other enquiries contact Kingspan Insulation on the numbers below:

- UK – Tel: +44 (0) 1544 388 601  
– email: [info@kingspaninsulation.co.uk](mailto:info@kingspaninsulation.co.uk)
- Ireland – Tel: +353 (0) 42 979 5000  
– email: [info@kingspaninsulation.ie](mailto:info@kingspaninsulation.ie)

*Kingspan Insulation Ltd. reserves the right to amend product specifications without prior notice. Product thicknesses shown in this document should not be taken as being available ex-stock and reference should be made to the current Kingspan Insulation price-list or advice sought from Kingspan Insulation's Customer Service Department (see above left). The information, technical details and fixing instructions etc. included in this literature are given in good faith and apply to uses described. Recommendations for use should be verified for suitability and compliance with actual requirements, specifications and any applicable laws and regulations. For other applications or conditions of use, Kingspan Insulation offers a Technical Advisory Service (see above), the advice of which should be sought for uses of Kingspan Insulation products that are not specifically described herein. Please check that your copy of this literature is current by contacting the Kingspan Insulation Marketing Department (see left).*

Kingspan Insulation Ltd is a member of:  
The National Insulation Association (NIA)



**Kingspan Insulation Ltd**  
Pembridge, Leominster, Herefordshire HR6 9LA, UK  
Castleblayney, County Monaghan, Ireland

[www.kingspaninsulation.co.uk](http://www.kingspaninsulation.co.uk) [www.kingspaninsulation.ie](http://www.kingspaninsulation.ie)